

Non-rotating Level Compensator

Features and Strengths

Non-rotating structure
 Reliable and precise pick up position for differences in height on the surface of material
 Configurations with varying sizes of spring and stroke



Specifications

Model	Stroke (mm)	Weight (g)	Material
L503CN	3	9.94	Al, SS, BS
L503CN-SS	3	10.4	
L507TN	7	18	
L507TN-SS	7	14.53	
L507TNL2-SS	7	23.7	
L507TNL2	7	19.14	
L510CN	10	12.84	
L510CN2-SS	10	16.79	
L510CN3-SS	10	13.37	
L510TNX-SS	10	38.21	
L520TN-SS	20	40.53	
L523TN-SS	23	29.48	
L525TXN	25	20.7	
L525TSN	25	20.6	
L525TUN	25	20.3	
L525TMN	25	20.1	
L1820TN	20	54	
L1850TN	50	140	
L3820TSN	20	82.4	

Build an Ordering No.

1. Level compensator	Description	Symbol
	Non-rotating level compensator, 3mm stroke, Connection – Fitting M5 female	L503CN
	Non-rotating level compensator, 3mm stroke, Stainless, Connection – Fitting M5 female	L503CN-SS
	Non-rotating level compensator, 7mm stroke, Connection – Fitting M5 female	L507TN
	Non-rotating level compensator, 7mm stroke, Stainless, Connection – Fitting M5 female	L507TN-SS
	Non-rotating level compensator, 7mm stroke, Stainless, Connection – Fitting M5 female	L507TNL2-SS
	Non-rotating level compensator, 7mm stroke, Connection – Fitting M5 female	L507TNL2
	Non-rotating level compensator, 10mm stroke, Connection – Fitting M5 female	L510CN
	Non-rotating level compensator, 10mm stroke, Stainless, Connection – Fitting M5 female	L510CN2-SS
	Non-rotating level compensator, 10mm stroke, Stainless, Connection – Fitting M5 female	L510CN3-SS
	Non-rotating level compensator, 10mm stroke, Stainless, Connection – Fitting M5 female	L510TNX-SS
	Non-rotating level compensator, 20mm stroke, Stainless, Connection – Fitting M5 female	L520TN-SS
	Non-rotating level compensator, 23mm stroke, Stainless, Connection – Fitting M5 female	L523TN-SS
	Non-rotating level compensator, 25mm stroke, Direct fitting connection for VB6X, VU1.5X, VU2X & VU4X	L525TXN
	Non-rotating level compensator, 25mm stroke, Direct fitting connection for VU10, VU15, VF15, VB10, VB12 & VB15	L525TSN
	Non-rotating level compensator, 25mm stroke, Direct fitting connection for VU4, VU6, VU8, VB5 & VB8	L525TUN
	Non-rotating level compensator, 25mm stroke, Direct fitting connection for VU2 & VU3	L525TMN
	Non-rotating level compensator, 20mm stroke, Connection – Fitting G1/8" male	L1820TN
	Non-rotating level compensator, 50mm stroke, Connection – Fitting G1/8" male	L1850TN
	Non-rotating level compensator, 20mm stroke, Connection – Fitting G3/8" male	L3820TSN

LEVEL COMPENSATORS

Dimension

[Unit : mm]

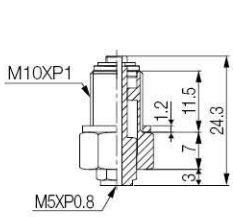

[L503CN-SS]

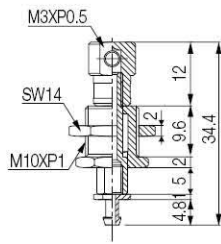

[L505TUN]

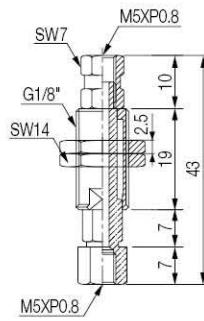

[L507TN]

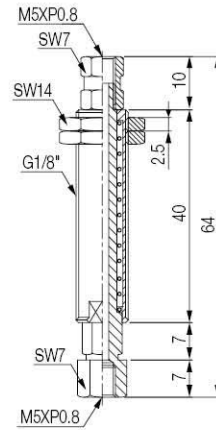

[L507TNL2-SS]

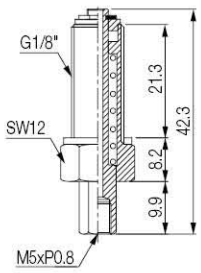

[L510CN]

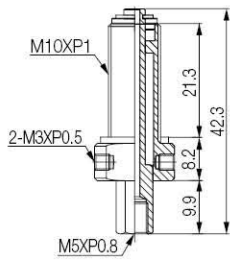

[L510CN2-SS]

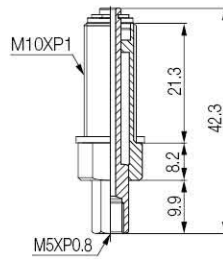

[L510CN3-SS]

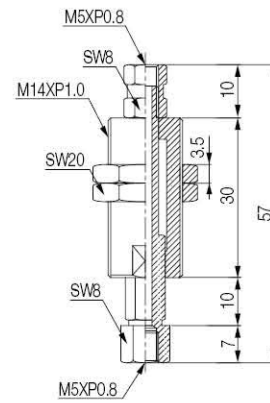

[L510TNX-SS]

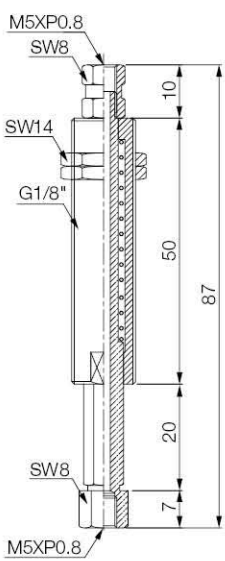

[L520TN-SS]

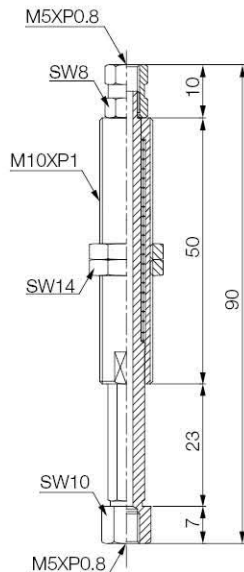

[L523TN-SS]

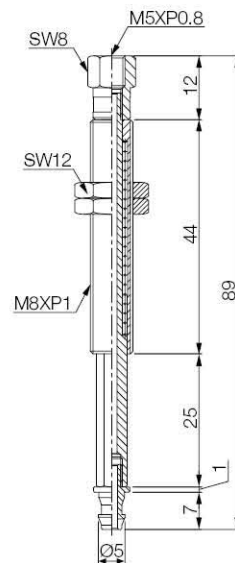

[L525TXN]

Dimension

[Unit : mm]

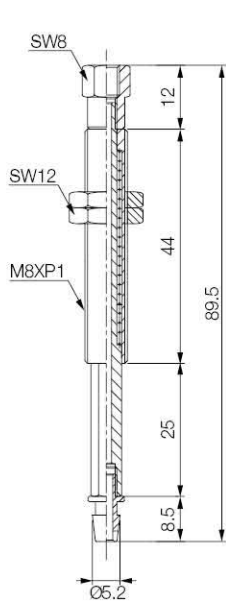

[L525TSN]

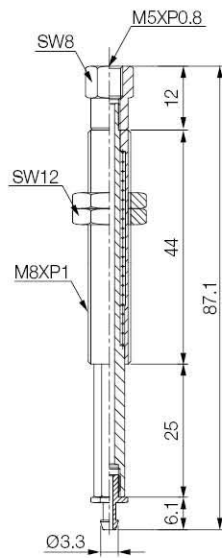

[L525TUN]

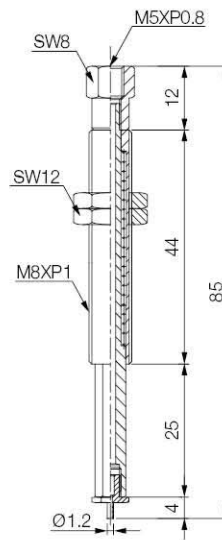

[L525TMN]

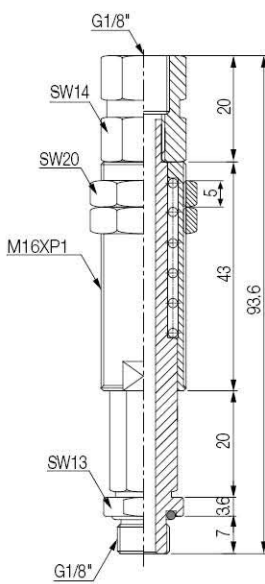

[L1820TN]

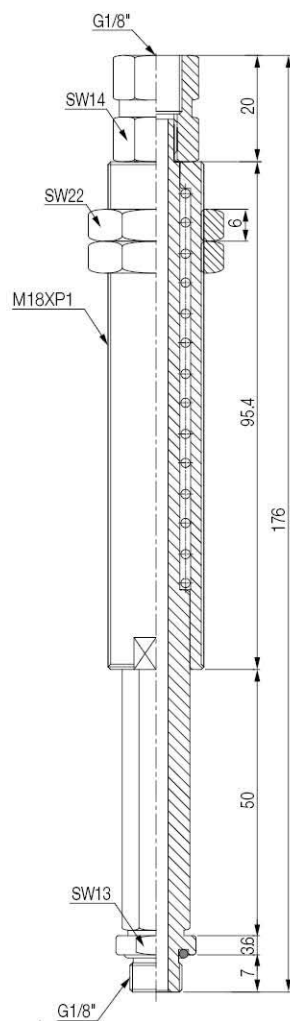

[L1850TN]

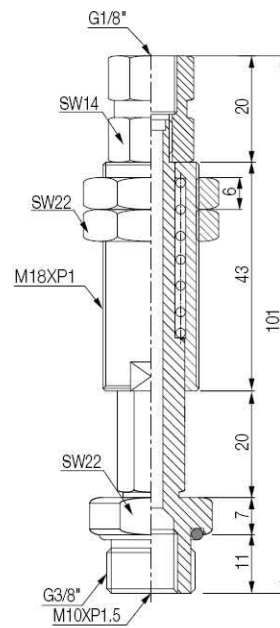

[L3820TSN]

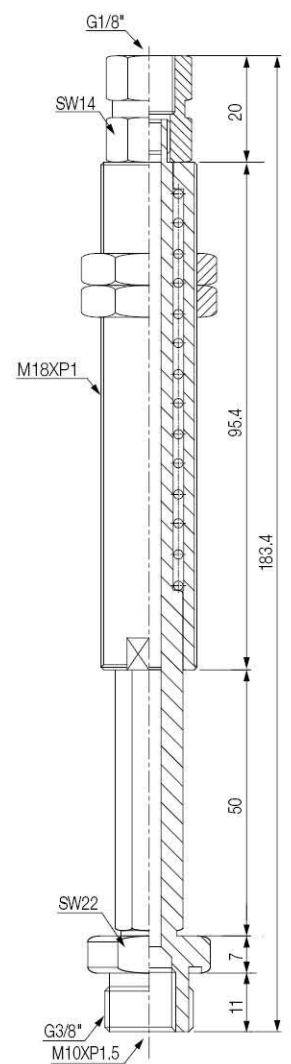

[L3850TSN]