

## Select Vacuum speeder

### • Select Vacuum Cartridge

- Choose the non-return valve option for sealed system applications to prevent immediate loss of vacuum and resulting release of product, etc due to an interrupted air supply.

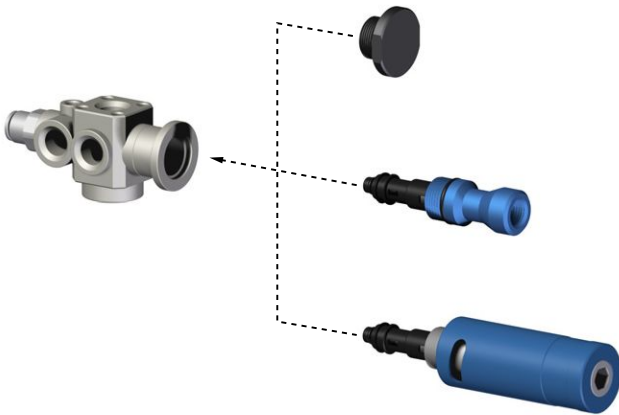

- ▶ Select a VSM (Vacuum Speeder) without a vacuum cartridge when using as a slave to another vacuum source; typically sealed applications or where fast response time is not required.
- ▶ Select a VSM with VMECA 2-stage VC202 Mini cartridge to provide sufficient vacuum flow (up to 41 NI/m) for sealed applications (i.e. sheet metal handling) or for low volume applications (i.e. small vacuum cups). Optional non-return valve available.\*
- ▶ Select a VSM with the VMECA 3-stage VC203 cartridge (vacuum flow up to 85 NI/m) for quick response time in high volume, sealed applications (i.e. large vacuum cups) or for non-sealed applications (i.e. cardboard handling) where high vacuum flow is required. Optional non-retrun valve is available.\*

### • Select mounting and mounting position



#### ▶ Option “F” - Direct Plate Mounting exm. ①

Mount directly to a plate (top mounting only) using the (4) M4 screws. (5) G1/8 plugs also included.



#### ▶ Option “M” - M8 Male Mounting exm. ②

Mount using M8 male fixed at factory in one of 3 specified positions (top, right, left). (4) G1/8 plugs are included. Left and right side mounting provides a lower profile vs. top mounting.

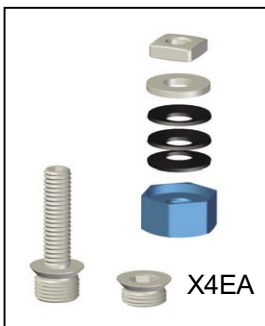

#### ▶ Option “P” - T - Slot Frame Mounting exm. ③, ④

Mount to appropriate t-slot frame in one of (3) positions (top, right, left) using (1) M8 27mm or (1) M6 22mm screw as specified with supplied nut and washers. (4) G1/8 plugs are included. Optional non-return valve is available.”

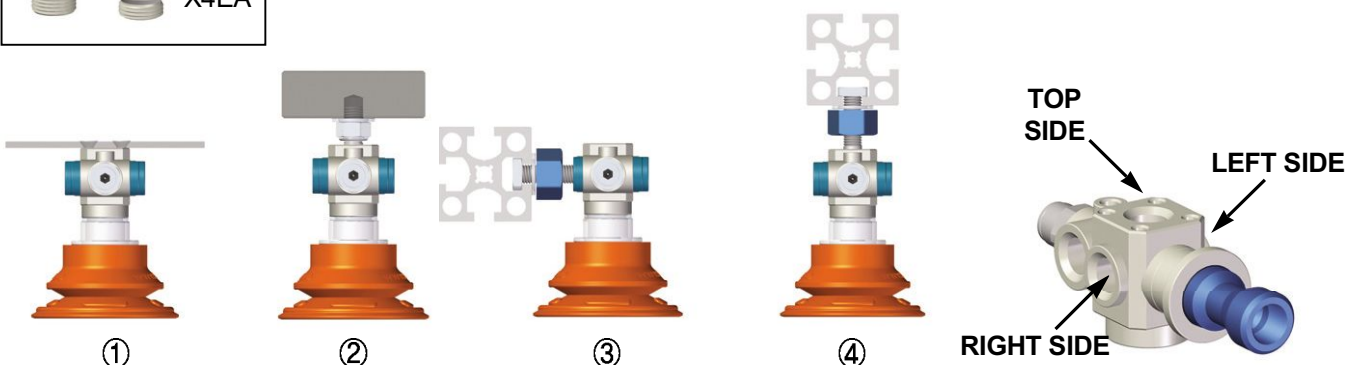

## VSM Example

 Compressed air

 Vacuum

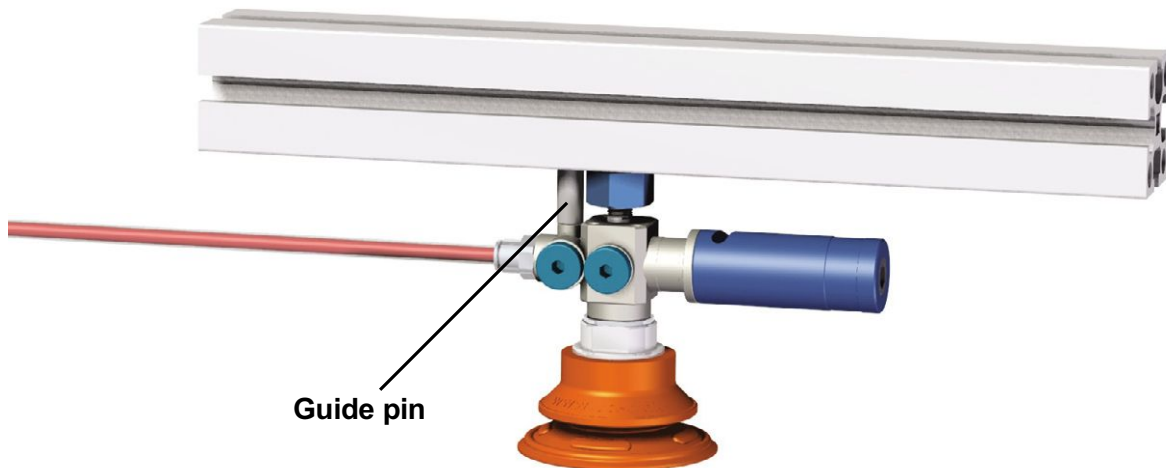

- ▲ To prevent the Vacuum Speeder from rotating when mounted in the top position use a guide pin inserted into the M5 port on the top of the VSM and extended into the t-frame slot.

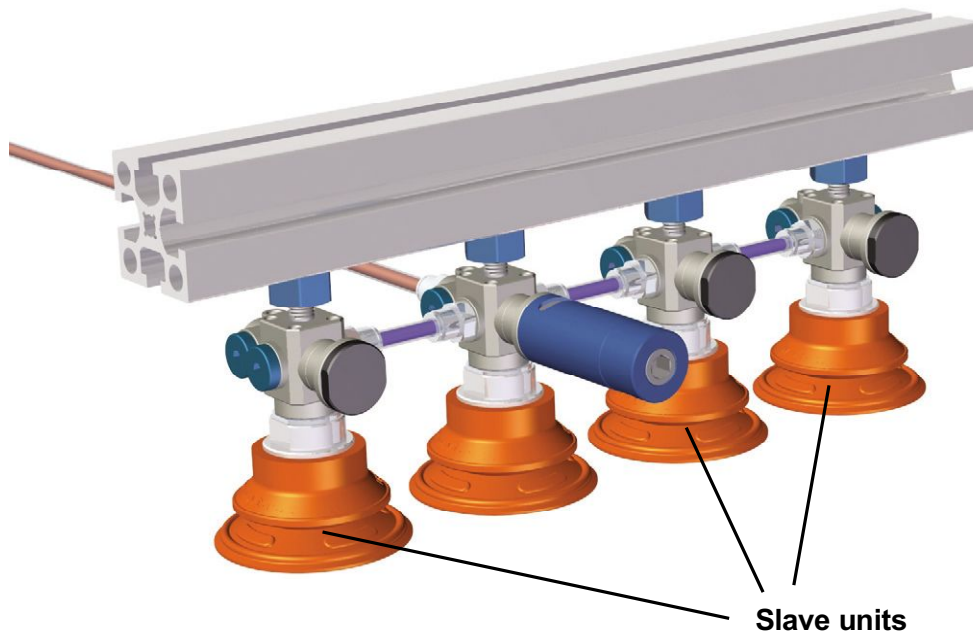

- ▲ Use a VSM (Vacuum Speeder) as a slave unit with vacuum supplied by another VSM in sealed applications or in applications where quick response time is not required.

## Example

### • VACUUM RELEASE

#### Type VSMR ▶

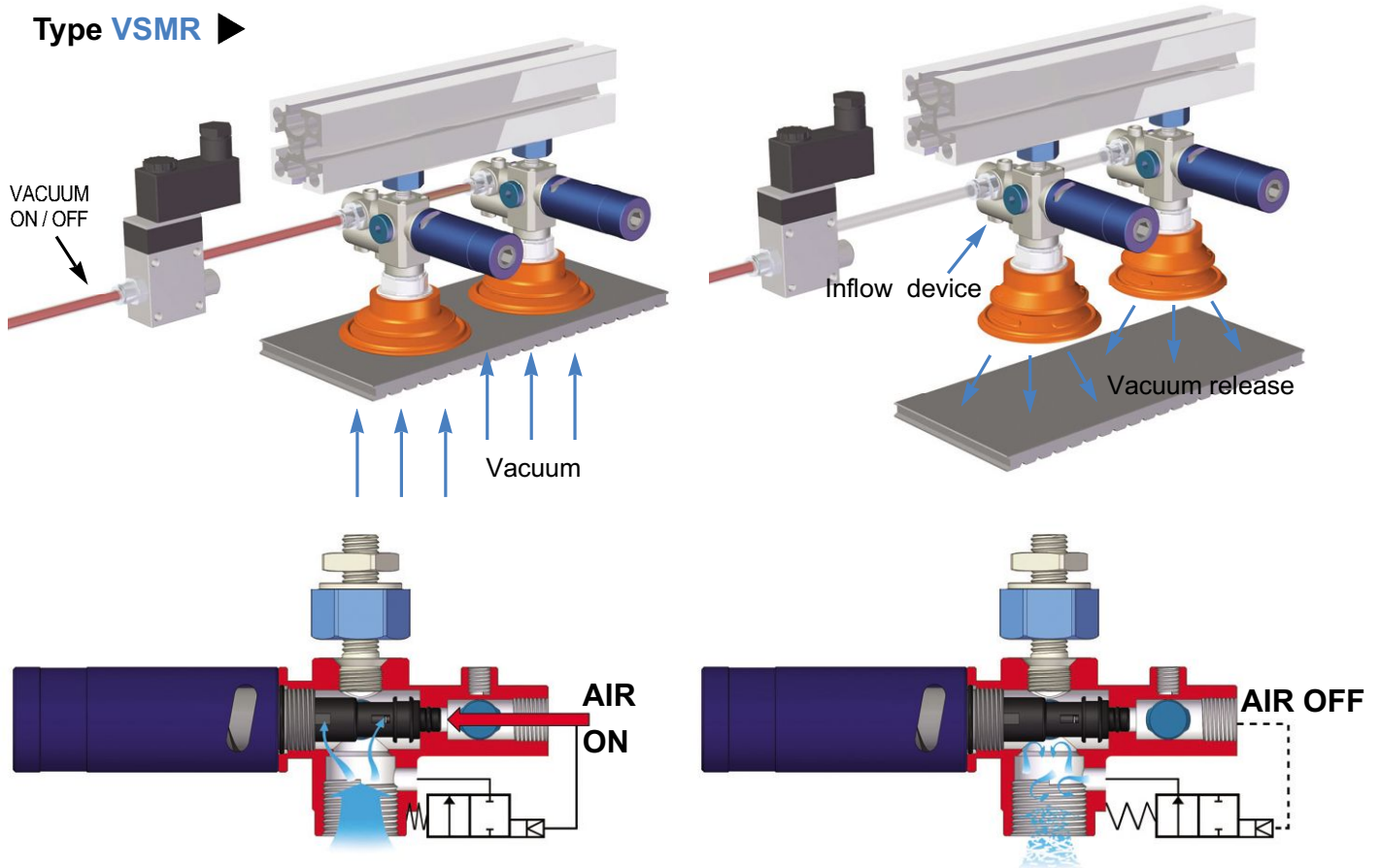

▲ Automatic faster release (blow-off) by inflow device of outside air is available **without any release control valve or line.** (Type VSMR / Patent pending)

#### Type VSM ▶

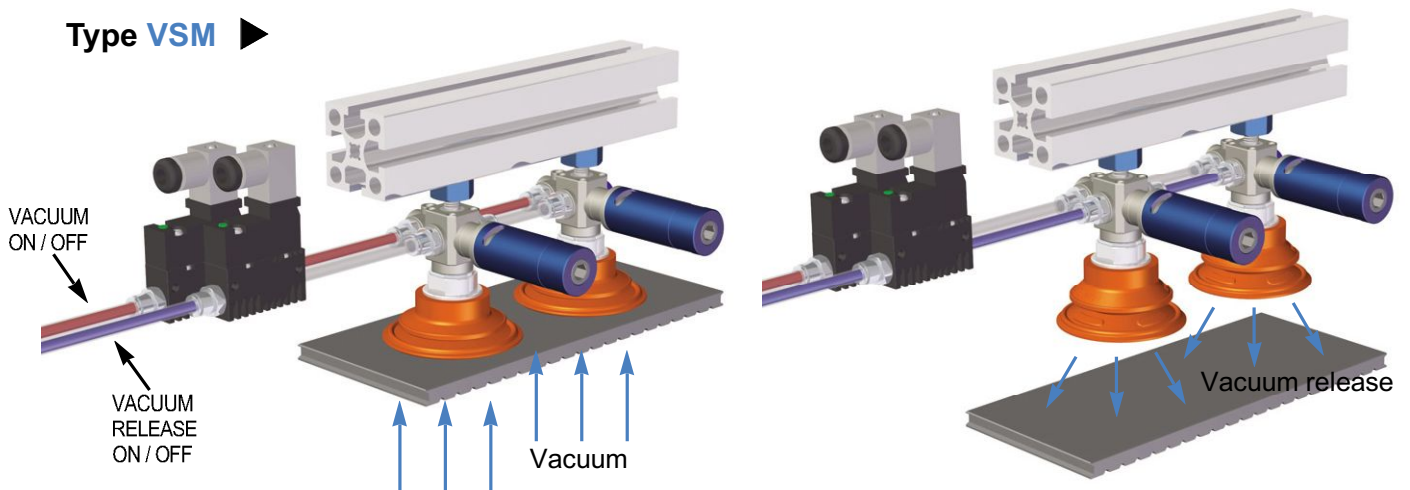

▲ Faster release (blow-off) and efficient cleaning of suction cup filters can be achieved by adding controlled compressed air to extra vacuum ports.



## Series VSMR..

- Max. vacuum level : -90kPa (-26.57 inHg)
- Max. flow rate : 85.8 NI/min (3.03 scfm)
- Supply air pressure : 3~6 bar, max 7 bar  
(43.5~87psi, max 101.5psi)
- Air consumption : 20~32 NI/min (0.7~1.13 scfm)
- Supply air type : Dry compressed air
- Working temperature : -20°C ~ +80°C
- Noise level : 55~65 dBA



### Main advantages

- Efficient individual and independent point-of-use vacuum.
- Extremely quick response.
- Multiple connection ports available
- Quick release system without release control valve.
- Maintains vacuum despite fluctuations and drops in air pressure.
- VMECA TWOFOLD SILENCER<sup>PT</sup> assures low noise levels.  
(about 30% lower than conventional silencer)

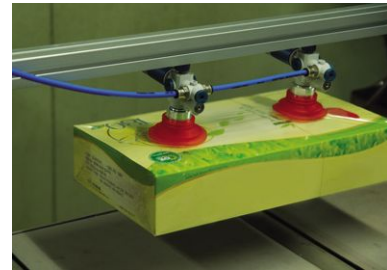

VACUUM SPEEDER

### Order No.

## VSMR 203 - PT8..VBF80 PU - 38M



▲ See pages 83-97

### ① Vacuum cartridge

- **203** - Vacuum cartridge VC203  
incl. twofold silencer



- 202 - Vacuum cartridge VC202  
incl. holding plug



### ② Mount and mounting position

- |              |   |  |
|--------------|---|--|
| F            | - 4x screw M4 top, 5x plug G1/8" (direct mount)                     |  |
| MT8          | - M8 16mm screw top, 4x plug G1/8" incl. mounting kit               |  |
| ML8          | - M8 16mm screw left, 4x plug G1/8" incl. mounting kit              |  |
| MR8          | - M8 16mm screw right, 4x plug G1/8" incl. mounting kit             |  |
| • <b>PT8</b> | - M8 27mm screw top, 4x plug G1/8" incl. profile kit with jam nut   |  |
| PL8          | - M8 27mm screw left, 4x plug G1/8" incl. profile kit with jam nut  |  |
| PR8          | - M8 27mm screw right, 4x plug G1/8" incl. profile kit with jam nut |  |
| PT6          | - M6 22mm screw top, 4x plug G1/8" incl. profile kit with jam nut   |  |
| PL6          | - M6 22mm screw left, 4x plug G1/8" incl. profile kit with jam nut  |  |
| PR6          | - M6 22mm screw right, 4x plug G1/8" incl. profile kit with jam nut |  |



## Series VSM..

- Max. vacuum level : -90kPa (-26.57 inHg)
- Max. flow rate : 85.8 NI/min (3.03 scfm)
- Supply air pressure : 3~6 bar, max 7 bar  
(43.5~87psi, max 101.5psi)
- Air consumption : 20~32 NI/min (0.7~1.13 scfm)
- Supply air type : Dry compressed air
- Working temperature : -20°C ~ +80°C
- Noise level : 55~65 dBA



## Main advantages

- Efficient individual and independent point-of-use vacuum.
- Extremely quick response.
- Multiple connection ports available
- Maintains vacuum despite fluctuations and drops in air pressure.
- VMECA TWOFOLD SILENCER<sup>PT</sup> assures low noise levels.  
(about 30% lower than conventional silencer)

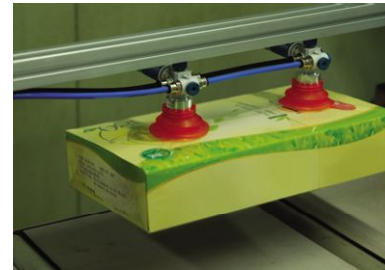

## Order No.

### VSM 203 - PT8..VBF80 PU - 38M

①

②

▲ See pages 83-97

#### ① Vacuum cartridge

203 - Vacuum cartridge VC203  
incl. twofold silencer

203 N - Vacuum cartridge VC203 with non-return valve  
incl. twofold silencer

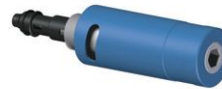

• 202 - Vacuum cartridge VC202  
incl. holding plug

202 N - Vacuum cartridge VC202 with non-return valve  
incl. holding plug



020 - No vacuum cartridge (slave unit)



#### ② Mount and mounting position

F - 4x screw M4 top, 5x plug G1/8" (direct mount)



MT8 - M8 16mm screw top, 4x plug G1/8" incl. mounting kit

ML8 - M8 16mm screw left, 4x plug G1/8" incl. mounting kit

MR8 - M8 16mm screw right, 4x plug G1/8" incl. mounting kit



• PT8 - M8 27mm screw top, 4x plug G1/8" incl. profile kit with jam nut

PL8 - M8 27mm screw left, 4x plug G1/8" incl. profile kit with jam nut

PR8 - M8 27mm screw right, 4x plug G1/8" incl. profile kit with jam nut

PT6 - M6 22mm screw top, 4x plug G1/8" incl. profile kit with jam nut

PL6 - M6 22mm screw left, 4x plug G1/8" incl. profile kit with jam nut

PR6 - M6 22mm screw right, 4x plug G1/8" incl. profile kit with jam nut



## Technical Data

Model	Feed pressure (MPa)	Air consumption (Nl/m)	Max. Vacuum level (-kPa)	Suction cup	Time, s/l, evacuate a volume to different vacuum level	
					-20 kPa	-60 kPa
VSMR 203.. VSM 203..	0.314	26	90	VB 30..	0.05	0.09
				VB40..	0.06	0.1
				VB50..	0.07	0.12
				VB75 (B)..	0.15	0.22
				VBF 30..	0.05	0.08
				VBF 40..	0.05	0.09
				VBF 50..	0.06	0.1
				VBF 60..	0.08	0.12
				VBF 80..	0.14	0.18
				VBF 100..	0.17	0.2
				VBL 30..	0.05	0.09
				VBL 40..	0.08	0.12
				VBL 50..	0.1	0.14
				VF 30..	0.04	0.07
				VF 40..	0.04	0.07
				VF 50..	0.05	0.08
				VF 75..	0.06	0.11
				VF 90..	0.07	0.12
				VF 110..	0.11	0.17
				VFC 50..	0.05	0.09
				VFC 60..	0.06	0.11
				VFC 75..	0.08	0.13
				VFC 90..	0.11	0.18
				VFC 100..	0.13	0.2
				VOU 15X45..	0.04	0.07
				VOU 20X60..	0.05	0.08
VOC 35X90..	0.06	0.11				
VOC 35X110..	0.07	0.13				
VOC 60X140..	0.13	0.15				
VOC 60X180..	0.16	0.18				
VSMR 202.. VSM 202..	0.314	26	90	VB 30..	0.06	0.09
				VB 40..	0.07	0.1
				VB 50..	0.08	0.13
				VB 75 (B)..	0.17	0.25
				VBF 30..	0.05	0.08
				VBF 40..	0.05	0.09
				VBF 50..	0.06	0.11
				VBF 60..	0.08	0.13
				VBF 80..	0.16	0.21
				VBF 100..	0.2	0.26
				VBL 30..	0.06	0.1
				VBL 40..	0.08	0.13
				VBL 50..	0.1	0.16
				VF 30..	0.04	0.07
				VF 40..	0.04	0.08
				VF 50..	0.05	0.09
				VF 75..	0.06	0.11
				VF 90..	0.07	0.12
				VF 110..	0.12	0.19
				VFC 50..	0.05	0.09
				VFC 60..	0.06	0.12
				VFC 75..	0.09	0.14
				VFC 90..	0.11	0.2
				VFC 100..	0.14	0.21
				VOU 15X45..	0.04	0.07
				VOU 20X60..	0.05	0.08
VOC 35X90..	0.06	0.12				
VOC 35X110..	0.07	0.14				
VOC 60X140..	0.15	0.2				
VOC 60X180..	0.17	0.22				

VACUUM SPEEDER

## Dimension

### ▼ VSMR 203..

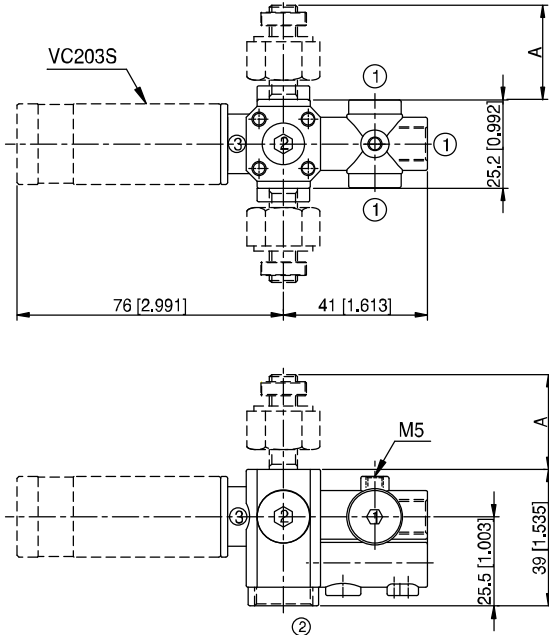

### ▼ VSM 203..

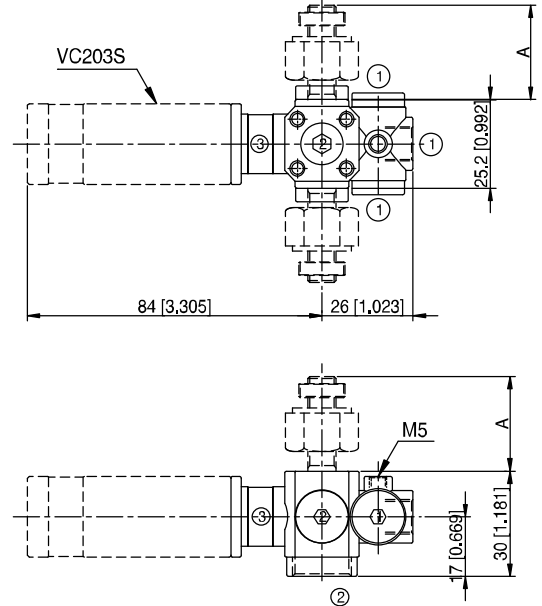

Measure unit : mm [inch]

Mounting	A
M□8	16
P□8	27
P□6	22

1. Compressed air : 3 x G1/8"
2. Vacuum : 1 x G3/8" and 3 x G1/8"
3. Exhaust

### ▼ VSMR 202..

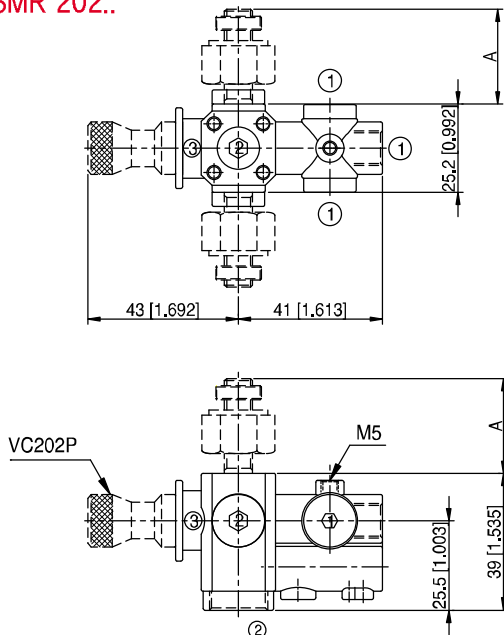

### ▼ VSM 202..

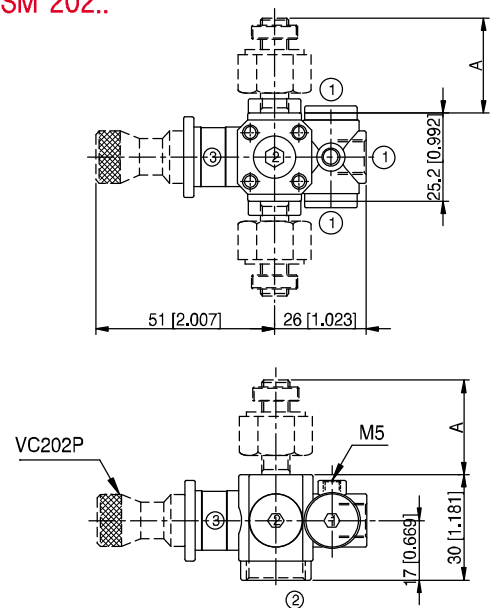

Measure unit : mm [inch]

Mounting	A
M□8	16
P□8	27
P□6	22

1. Compressed air : 3 x G1/8"
2. Vacuum : 1 x G3/8" and 3 x G1/8"
3. Exhaust

Refer to page 83~97 about dimension of suction cups.