

## VB( )X Series



### Features

- ▶ Suitable for thin film suction
- ▶ Prevent the object is sucked into the suction cup in vacuum working
- ▶ Lower height compared to std. VB cups for easier space utilization.



### Material Specification

Material	Hardness Shore (°)	Color	Temperature (°C)
NBR	60	Black	-20 ~ 110
Silicone	55	Red	-70 ~ 200
White Silicone	55	Translucent White	-70 ~ 200
White Silicone(FDA)	55	Translucent White	-70 ~ 200
High temp. Silicone	50	Blue	-70 ~ 280
Conductive Silicone	70	Smoky Black	-45 ~ 95
Mark Free	75	Black	-10 ~ 100

## VB17X



### Recommended Lifting Force (Max.)

Model	Volume (cm <sup>3</sup> )	Lifting Force (Kg) - Perpendicular			Lifting Force (Kg) – Parallel		
		- 20 kPa	- 60 kPa	- 90 kPa	- 20 kPa	- 60 kPa	- 90 kPa
VB17X	0.51	0.32	0.74	0.88	0.29	0.44	0.53

※ the lifting force above does not include safety factor

### Ordering No Example.

VB17X - S - M5M

1. Suction Cup      2. Fitting

1. Suction Cup	Description	Ordering No.
	Single-bellow suction cup, 17mm diameter, Nitrile (NBR)	<a href="#">VB17X-N</a>
	Single-bellow suction cup, 17mm diameter, Silicone	<a href="#">VB17X-S</a>
	Single-bellow suction cup, 17mm diameter, White Silicone	<a href="#">VB17X-WS</a>
	Single-bellow suction cup, 17mm diameter, White Silicone(FDA)	<a href="#">VB17X-WS(FDA)</a>
	Single-bellow suction cup, 17mm diameter, High temperature Silicone	<a href="#">VB17X-HS</a>
	Single-bellow suction cup, 17mm diameter, Conductive Silicone	<a href="#">VB17X-CS</a>
	Single-bellow suction cup, 17mm diameter, Mark Free	<a href="#">VB17X-A</a>

2. Fitting	Description	Ordering No.
	Fitting, M5 male	<a href="#">M5M</a>

### Dimension

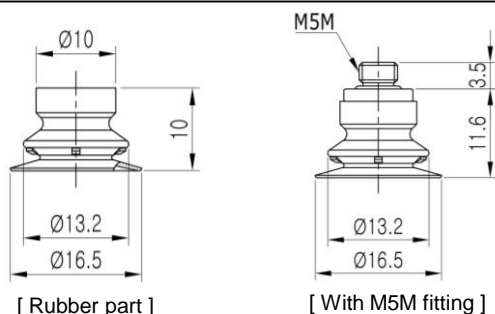

[ Unit : mm ]

## VB20X



### Recommended Lifting Force (Max.)

Model	Volume (cm <sup>3</sup> )	Lifting Force (Kg) - Perpendicular			Lifting Force (Kg) – Parallel		
		- 20 kPa	- 60 kPa	- 90 kPa	- 20 kPa	- 60 kPa	- 90 kPa
VB20X	0.16	0.45	1.24	1.64	0.28	0.6	1.2

※ the lifting force above does not include safety factor

### Ordering No Example.

VB20X - S - M5M

1. Suction Cup

2. Fitting

1. Suction Cup	Description	Ordering No.
	Single-bellow suction cup, 17mm diameter, Nitrile (NBR)	<a href="#">VB20X-N</a>
	Single-bellow suction cup, 17mm diameter, Silicone	<a href="#">VB20X-S</a>
	Single-bellow suction cup, 17mm diameter, White Silicone	<a href="#">VB20X-WS</a>
	Single-bellow suction cup, 17mm diameter, White Silicone(FDA)	<a href="#">VB20X-WS(FDA)</a>
	Single-bellow suction cup, 17mm diameter, High temperature Silicone	<a href="#">VB20X-HS</a>
	Single-bellow suction cup, 17mm diameter, Conductive Silicone	<a href="#">VB20X-CS</a>
	Single-bellow suction cup, 17mm diameter, Mark Free	<a href="#">VB20X-A</a>

2. Fitting	Description	Ordering No.
	Fitting, M5 male	<a href="#">M5M</a>

### Dimension

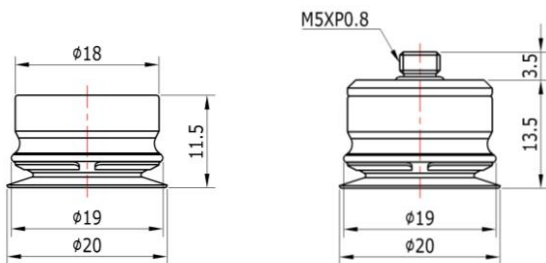

[ Rubber part ]

[ With M5M fitting ]

[ Unit : mm ]